

FEATURES

- Magnetic shielded.
- Good Q factor, good energy storage and low resistance.



APPLICATIONS

- Ideally used in Notebook PC, LCD TV,DVD, Game machine, STB ,Projectoretc as DC-DC converter inductors.

PRODUCT IDENTIFICATION

DSS 5022 - 4R7 M - T
a b c d e

- a : Series name
- b : Product dimensions
- c : Inductance Value (1R0:1.0uH; 100: 10uH; 101:100uH)
- d : Inductance Tolerance (K:10% ; M:20% ; N:30%)
- e : Packaging style (T: Taping; B: bulk)

SHAPES AND DIMENSIONS Unit: mm

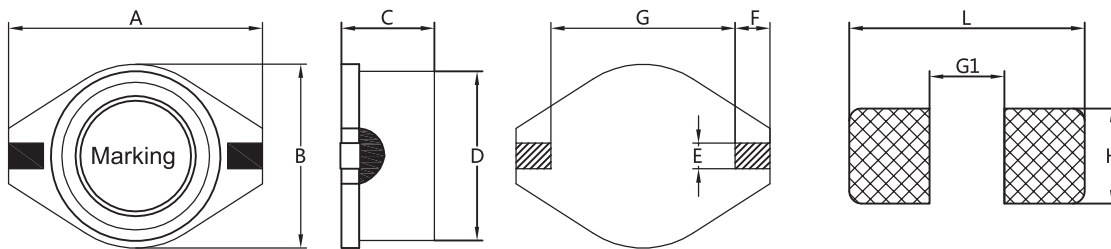

Series	Dimensions(mm)									
	A	B	C	D	E	F	G	L	G1	H
DSS3316	12.95Max.	9.40Max.	5.21Max.	8.38	2.54	2.54	7.62	13.5	7.3	3.0
DSS5022	18.54Max.	15.24Max.	7.11Max.	12.7	2.54	2.54	12.7	20.1	10.3	3.0

ELECTRICAL CHARACTERISTICS

Part Number	L(uH)	Test Freq.(KHz)	DCR max.(Ω)	Isat.(A)	Irms.(A)	SRF(MHz)
DSS3316-1R0MT	1.0	100	0.021	5.60	5.00	140.0
DSS3316-1R5MT	1.5	100	0.022	5.20	4.50	120.0
DSS3316-2R2MT	2.2	100	0.032	5.00	3.80	80.0
DSS3316-3R3MT	3.3	100	0.039	3.90	3.30	70.0
DSS3316-4R7MT	4.7	100	0.054	3.20	2.70	40.0
DSS3316-6R8MT	6.8	100	0.075	2.80	2.20	38.0
DSS3316-100MT	10	100	0.101	2.40	2.00	35.0
DSS3316-150MT	15	100	0.150	2.00	1.50	25.0
DSS3316-220MT	22	100	0.207	1.60	1.30	19.0
DSS3316-330MT	33	100	0.334	1.40	1.10	15.0
DSS3316-470MT	47	100	0.472	1.00	0.80	13.0
DSS3316-680MT	68	100	0.660	0.90	0.70	10.0
DSS3316-101MT	100	100	1.110	0.80	0.60	7.0
DSS3316-151MT	150	100	1.550	0.60	0.50	6.0
DSS3316-221MT	220	100	2.000	0.50	0.40	5.0

Part Number	L(uH)	Test Freq.(KHz)	DCR max.(Ω)	Isat.(A)	Irms.(A)	SRF(MHz)
DSS5022-100MT	10	100	0.040	8.00	3.90	30.0
DSS5022-150MT	15	100	0.048	7.00	3.40	20.0
DSS5022-220MT	22	100	0.059	6.00	3.10	18.0
DSS5022-330MT	33	100	0.075	5.00	2.80	14.0
DSS5022-470MT	47	100	0.097	4.00	2.40	10.0
DSS5022-680MT	68	100	0.138	3.00	2.00	9.0
DSS5022-101MT	100	100	0.207	2.40	1.70	7.0
DSS5022-151MT	150	100	0.293	2.10	1.30	6.0
DSS5022-221MT	220	100	0.470	1.90	1.10	5.0
DSS5022-331MT	330	100	0.780	1.10	0.86	4.0
DSS5022-471MT	470	100	1.080	1.10	0.73	3.0
DSS5022-681MT	680	100	1.400	0.96	0.64	2.5
DSS5022-102MT	1000	100	2.010	0.80	0.53	2.0

Note:

Isat: DC current at which the inductance drops 30% from its value without current.

Irms: DC current that causes the temperature rise ($\Delta T = 40^{\circ}\text{C}$) from 20°C ambient